

NOTES
 MATERIAL:
 COLOR: RAL 7047
 FINISH: Powder Coat
 OTHER NOTES: ~

ITEM NO.	PART NUMBER	DESCRIPTION	TW/QTY.
1	QSSB200-12	New Super Stand U-leg 12"	1
2	SS202	Double Sided Saddle	2
3	SS248	48" Rail w/ long slots	2
4	HDKSB03	Hardware kit for QSSB248	1
5	HDKSB02	Hardware kit for QSSB201	1

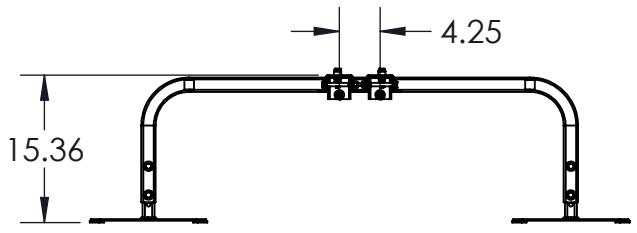
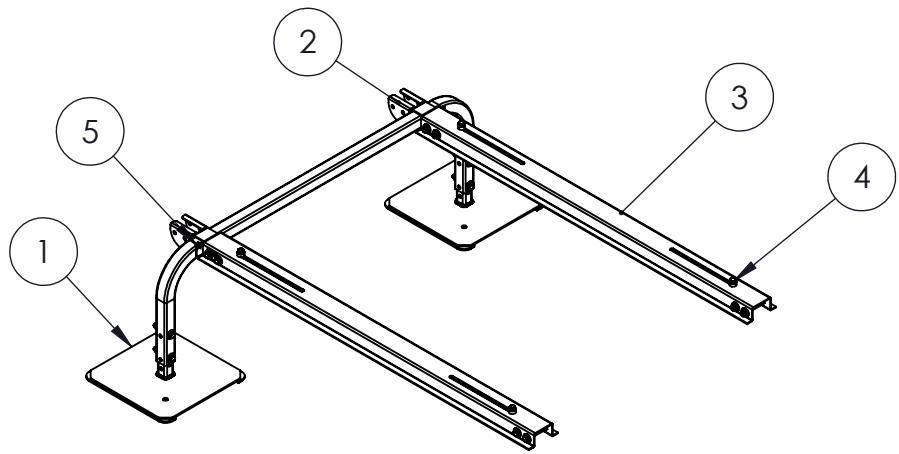
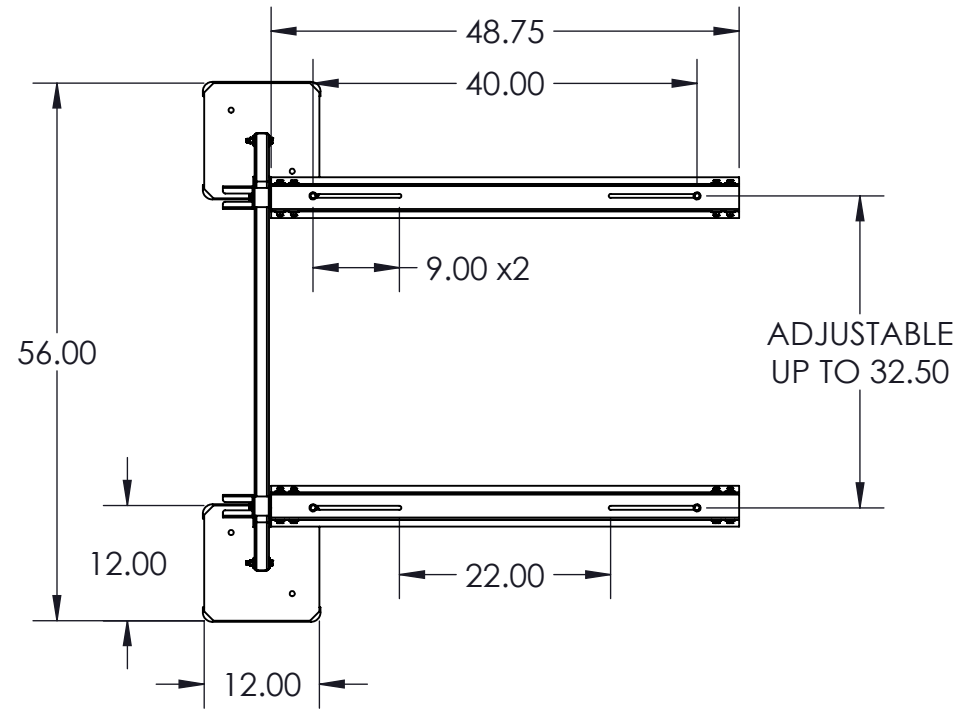

THIS UNIT CONSISTS OF:
 (1) QSSX2000-12
 (1) QSSB248

ALL DRAWINGS AND WRITTEN MATERIAL CONTAINED HEREIN ARE THE PROPERTY OF DIVERSITECH CORP AND MAY NOT BE DUPLICATED OR DISCLOSED AT ANY TIME UNLESS APPROVED IN WRITING BY DIVERSITECH CORP INTERPRET THIS DRAWING IN ACCORDANCE WITH ASME Y14.5-2009 DIMENSIONING AND TOLERANCING STANDARDS	UNLESS OTHERWISE SPECIFIED DIMENSIONS & TOLERANCES ARE IN INCHES / [mm]			MATERIAL: SEE NOTES FINISH: SEE NOTES *DO NOT SCALE*			TITLE		SIZE
	ANG. MACH. ±0.25° ANG. BEND ±1°						Super Stand Ext w/ 48" rails & 12" Feet		B
	DECIMALS INCHES [mm]			THIRD ANGLE PROJECTION	NAME	DATE	DRAWING NUMBER		REVISION
	X ±0.1 ±2 X.X ±0.05 ±0.1 X.XX ±0.005 ±0.02 X.XXX ±0.002 ±N/A				DRAWN	AMP	13 Feb 19	QSSX48-12	
				MFG APPR.		SCALE: 1:2 0	WT. (lbs):	SHEET 1 OF 1	